



# Europa Filter

## DIN 19605

Bobbin wound FRP-Filter DIN 19605, complete with plate and sprayer nozzles (min. 70 units/sqm) and side manhole Ø 400-500, upper manhole from Ø 150 to 500, sightglass Ø150-210-300. PN 10 in/out Flanges, water drain, air outlet, round base in fiberglass. Constructed in Isophthalic resin and Liner in DIN 18820 Vinylestere Gel-Coat.



Pressure **2,5 bar**

Temp. max **50 °C**



97/23/EC  
CE 0948  
BS 4994

Certified  
KSW-KTW  
Prüfung

Tested  
AD Merkblatt  
N.1

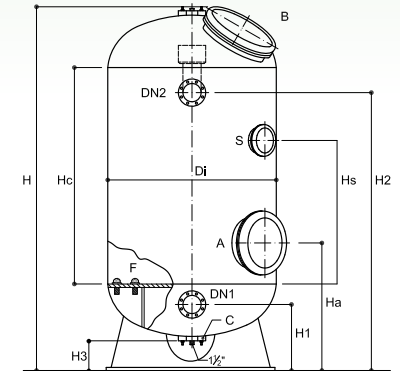

Ø mm	600	750	800	850	900	1000	1100	1200	1250	1400	1500	1600	1800	1900	2000	2200	2400	2500
H mm ( Hc 1500 )	2100	2100	2100	2150	2150	2250	2250	2300	2350	2400	2450	2500	2550	2600	2700	2750	2800	3000
H1 mm	200	200	200	200	200	250	250	300	300	300	300	300	300	300	350	350	350	500
H2 mm ( Hc 1500 )	1600	1600	1600	1600	1600	1650	1650	1700	1700	1750	1750	1800	1800	1800	1850	1850	1850	2000
A Ø mm	400	400	400	400	400	400	400	400	400	400	400	400	500	500	500	500	500	500
B Ø mm	150	150	210	210	210	300	300	300	400	400	400	400	400	500	500	500	500	500
C DN	50 1"	50 1"	50 1"	50 1"	50 1"	100 1"	100 1"	100 1"	100 1" 1/2	100 1" 1/2	100 1" 1/2	100 1" 1/2	100 1" 1/2	100 2"	100 2"	100 2"	100 2"	100 2"
D DN	50	50	50	50	50	50	50	50	50	50	50	50	100	100	100	100	100	150
Flanges in/out ( 1/2 ) DN	50	50	65	65	80	80	100	100	125	125	125	150	150	150	200	200	200	250
Nozzles filtering ( F ) pz.	20	33	37	42	47	58	70	84	92	115	132	150	195	215	235	285	340	370
Surface filter m <sup>2</sup>	0,28	0,44	0,51	0,56	0,63	0,78	0,95	1,13	1,22	1,54	1,76	2,01	2,54	2,83	3,14	3,81	4,52	4,91
Q ( V = 30 m/h ) mc/h	9	13	15	17	19	24	29	34	37	46	53	60	76	85	95	114	136	147